

## MEADOW ROAD

FELTHAM, TW13 5JA

£484,950  
FREEHOLD

Welcome to this stunning new build end terrace house located on this quiet residential road. This contemporary home boasts three bedrooms, making it an ideal choice for families or those seeking extra space. With two modern bathrooms, morning routines will be a breeze, ensuring convenience for all residents.

As you enter, you will be greeted by an inviting long hallway leading to an open plan kitchen and dining area, perfect for entertaining guests or enjoying family meals. The design maximises space and light, creating a warm and welcoming atmosphere throughout the home.

The property also features off street parking, a valuable asset in today's busy world, and a lovely rear garden, providing a private outdoor space for relaxation or play.

With a 10 year builder's warranty, you can have peace of mind knowing that this home is built to the highest standards. Situated in Feltham, you will benefit from a range of local amenities, schools, and excellent transport links, making it a convenient location for both work and leisure.



Meadow Road, Feltham

Approximate Gross Internal Area  
861 sq ft - 80 sq m (Excluding Garden)

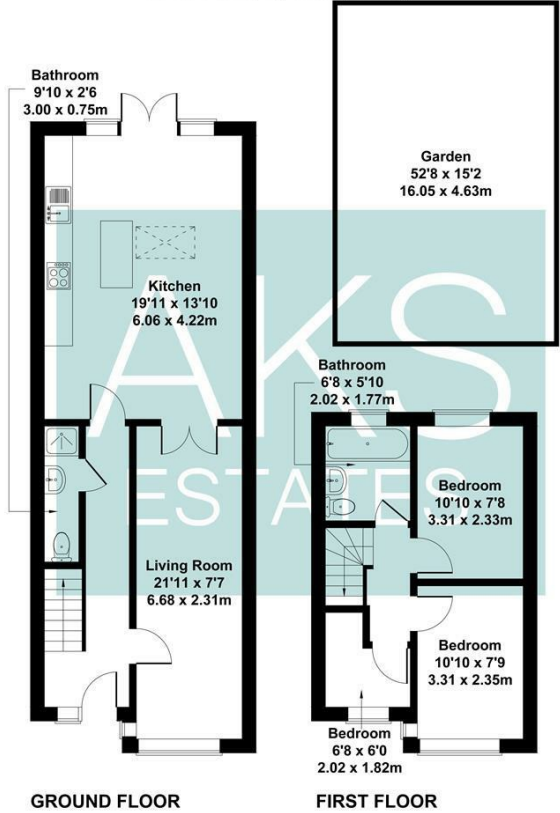

Not to Scale. Produced by The Plan Portal 2025  
For Illustrative Purposes Only.



Energy Efficiency Rating		
	Current	Potential
Very energy efficient - lower running costs		
(92 plus) A		
(81-91) B		
(69-80) C	82	82
(55-68) D		
(39-54) E		
(21-38) F		
(1-20) G		
Not energy efficient - higher running costs		
England & Wales	EU Directive 2002/91/EC	

Agents Note: Whilst every care has been taken to prepare these particulars, they are for guidance purposes only. All measurements are approximate and are for general guidance purposes only and whilst every care has been taken to ensure their accuracy, they should not be relied upon and potential buyers/tenants are advised to recheck the measurements

Heston  
131A Heston Road  
Hounslow  
TW5 0RF

020 8059 0595  
shiv@aksestates.co.uk  
aksestates.co.uk

AKS  
ESTATES